



THAME
ENGINEERING

SERRATED SOFT JAWS SECTION

This is the index page for the serrated soft jaws section. Click on the bullet list item below to take you directly to any section within this document.

If this is NOT the correct section, close this window and choose a new section from the 'Jaws Home' page.

INDEX

60° Metric

- for Hardinge, Howa, Kitagawa, Leader, Matsumoto (MMK), Pratt Burnerd, Rohm, Schunk & SMW Autoblok.
- for Gamet, Nikko & Rohm chucks

90° Imperial

- for SMW Autoblok large bore chucks, Pratt Burnerd Close/Open Centre Wedge Power Chucks, Constant Grip chucks and Self Contained Power Chucks.
- for SMW Autoblok, Berg, Forkardt, Gamet, Geiger & Haag, Pratt Burnerd, Rohm, Schunk & SMW
- for Berg KH Power Chucks, Schunk & SMW Autoblok Pneumatic Chucks, Schunk & SMW Autoblok Big Bore Power Chucks and Rohm KFD-HS Power Chucks
- for Autoblok, Forkardt, Geiger & Haag, Rohm & SMW 2-JAW Power Chucks, Gamet Power Chucks and Coventry & Tudor Manual Chucks



THAME
ENGINEERING

SERRATED SOFT TOP JAWS

60° SERRATIONS

- Material : 080M15 (En32)
- Black Finish

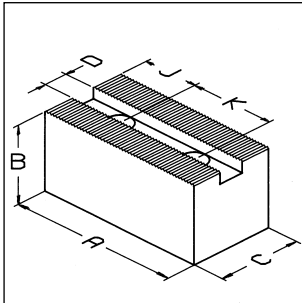

TYPE A

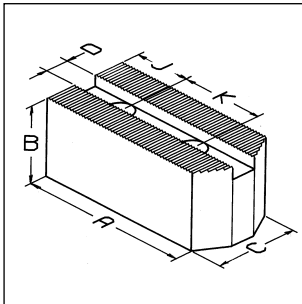

TYPE B

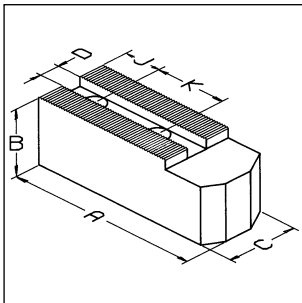

TYPE C

THAME PART No.	A	B	C	D	K + J BOLT	SERRATIONS	TYPE	WEIGHT Kg/Set
BO 04	48	25	20	8	15 + 8 M6	1.5mm × 60°	A	0.5
BR 05	50	25	25	10	14 + 10 M8	1.5mm × 60°	B	0.5
DK 05	55	50	25				A	1.1
BO 05	57	32	25	10	18 + 10 M8	1.5mm × 60°	B	0.8
DJ 05	57	50	25				A	1.3
CK 05	62	25	25	10	19 + 8 M8	1.5mm × 60°	B	0.9
DU 05	48	25	25	11	16 + 9.5 M8	1.5mm × 60°	A	0.7
CK 06	80	35	30	11	25 + 14 M8	1.5mm × 60°	C	1.4
BX 13	52	25	25	12	14 + 8 M8	1.5mm × 60°	A	0.8
BX17	70	30	30	12	17 + 11 M10	1.5mm × 60°	A	1.1
BO 06	72	38	32	12	20 + 15 M10	1.5mm × 60°	A	1.6
BA 06	72	30	30				B	1.0
BQ 06	72	32	32				A	1.1
DJ 06	72	57	32				A	3.5
PT 06	82	32	32				B	1.3
BP 06	72	38	32	12	20 + 15 M10	3mm × 60°	A	1.6
BO 08	95	44	32	14	25 + 25 M12	1.5mm × 60°	A	2.7
BA 08	95	38	32				B	2.4
DJ 08	95	70	32				A	4.0
CK 08	85	44	32	14	25 + 20 M12		C	2.2
BQ 08	90	38	32				A	2.2
CK 09	95	44	32				C	2.7
PT 08	102	44	32				B	2.9
BP 08	95	44	32	14	25 + 25 M12	3mm × 60°	A	2.7
DU 08	85	40	40	16	25 + 20 M12	1.5mm × 60°	A	2.8
DU 09	85	60	40				A	4.0
BO 10	110	40	40	16	30 + 30 M12	1.5mm × 60°	A	3.4
BA 10	110	40	40				B	3.1
BR 10	110	60	40				A	4.5
DJ 10	110	80	40				A	6.5
PT 10	125	40	40				B	4.5
DK 10	90	60	40	16	30 + 21 M12		A	4.2
DK 11	110	60	40				C	5.2



THAME
ENGINEERING

To Suit Hardinge, Howa, Kitagawa, Leader, Matsumoto, Pratt Burnerd, Röhme, Schunk & SMW-Autoblok Power Chucks

CHUCK Ø	HARDINGE	HOWA	KITAGAWA	LEADER	MATSUMOTO (MMK)	PRATT BURNERD	RÖHM	SCHUNK	SMW-AUTOBLOK
110			B-04 HOB-4						
105 110 135	4" SURE-GRIP 5" SURE-GRIP	HO1MA4 HO24M5	B204 AS110 N-04 HJ-4 B205		H-4-21		KFD-HE 130 KFN 105		
135			HOB-5 B-05						
135		HO1MA5	HJA-4 N-05		HXA5-6-34 HHXA 5-6 SA 5-6-40				
110 135		HO27M4 HO27M5							
165					HA5-6 HH-6 HX-6 HJ-6 H-6 STC-6 ZA-5-6				
125, 150						9827-TORNADO 150 KB			
170						9827-TORNADO 170 KB			
165 170 210	6" SURE-GRIP	HO7MA6 HO15MA6 HO22M6 HO24M6 HO27M6 HO37M6 HO47M6 HO23M8	HJA5-6 N-06 HOS-6 HOB-6 AS-165 B206 B-160 HO-6 B-06 NL-06 HOH-160 BT206 HOH-06 HOH206 N-160 B-07, BB06 BL 206 B-106 HG738-165	LC165		INTERNATIONAL 9821-21723 9821-31723 HIGH SPEED QUICK CHANGE 9121-21723 9121-31723	KFD-HE 170	ROTA NCK165 HSL 165 ROTA NC165 ROTA NCF165	BBM 175
165		HO1MA6							
210	8" SURE-GRIP	HO7MA8 HO15M8	B200 B208 B-08 HOB-8 N-200 HOH-200 N-08 HOH-8 AS-210 NL-08 HOS-8 BT208 HJA6-8 HOH208 HO-8 HOH108 B-108 BB-08 BL 208 HG715-210	LC210	HA6-8 HX-8 H-8 HH-8 HJ-8 HHJ-8 STC-8 ZA6-8-52 ZA6-8-66	INTERNATIONAL 9821-32123 9821-42123 9827-TORNADO HIGH SPEED QUICK CHANGE 9121-32123 9121-42123 210 KB	KFD-HE 210	ROTA NCK 210 HSL 210 ROTA NC210 ROTA NCF210	BBM 210
210		HO1MA8							
210		HO27M8 HO47M8 HO24M8 HO22M8 HO37M8 HO7MA10 HO23M10 HO15M10							
250 254 265	10" SURE-GRIP		B250 B-10 HOH-250 HOH-10 B210 HOB-10 AS-250 N-250 N-10 HJA6-10 HJA8-10 HOS-10 HO-10 NL-10 BT210 B-110 UVE-K200 HOH110 UVE-K250 HOH210 BL210 HG730-254	LC250	HA6-10 HA8-10 ZA6-10-75 H-10 HX-10 HHL-10 HH-10 HHJ-10 HJ-10 HA8-11 STC-10	INTERNATIONAL 9821-42623 9821-52623 9827-TORNADO HIGH SPEED QUICK CHANGE 9121-42623 9121-52623 265 KB	KFD-HE 254	ROTA NCK 250 HSL 250 ROTA NC 250 ROTA NCF250	BBM 250



THAME
ENGINEERING

SERRATED SOFT TOP JAWS

60° SERRATIONS

- Material : 080M15 (En32)
- Black Finish

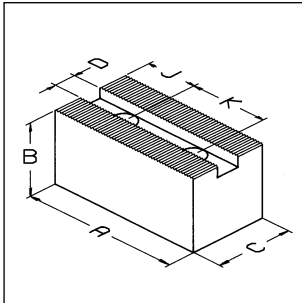

TYPE A

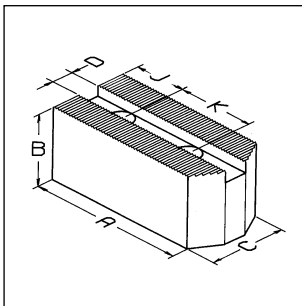

TYPE B

THAME PART No.	A	B	C	D	K + J BOLT	SERRATIONS	TYPE	WEIGHT Kg/Set
BP 10	110	40	40	16	30 + 30 M12	3mm x 60°	A	3.4
DU 10	105	40	40	18	30 + 24 M14	1.5mm x 60°	A	4.4
DU 11	105	60	40				A	6.6
BO 12	130	50	50	18	30 + 40 M14	1.5mm x 60°	A	6.8
DJ 12	130	80	50				A	10.9
DJ 14	130	100	50				A	13.6
PT 12	145	50	50				B	7.3
BP 12	130	50	50	18	30 + 40 M14	3mm x 60°	A	6.8
BR 13	130	50	50	21	30 + 40 M16	1.5mm x 60°	A	6.5
DJ 13	130	80	50				A	11.0
PT 13	145	50	50				B	7.3
DU 12	111	65	50	21	35 + 25 M16	1.5mm x 60°	A	7.1
BO 15	165	76	64	22	43 + 37 M20	1.5mm x 60°	A	15.2
DJ 15	165	127	64				A	25.0
BR 15	135	60	50	25.5	43 + 26 M20	1.5mm x 60°	A	8.2
BO 16	156	76	64	22	60 + 36 M20	1.5mm x 60°	A	14.5
CK 15	150	76	64	22	50 + 30 M20	3mm x 60°	A	13.8
BO 18	180	76	64	25	60 + 40 M20	3mm x 60°	A	16.5
DJ 18	180	127	64				A	29.0
BO 24	210	102	76	25	80 + 40 M20	3mm x 60°	A	32.3



ALTERNATIVE USES FOR TEC CHUCK JAWS NO: 426. THE SERRATED JAW.



THAME
ENGINEERING

To Suit Howa, Kitagawa, Leader, Matsumoto, Pratt Burnerd, Röhm, Schunk & SMW-Autoblok Power Chucks

CHUCK Ø	HOWA	KITAGAWA	LEADER	MATSUMOTO (MMK)	PRATT BURNERD	RÖHM	SCHUNK	SMW- AUTOBLOK
254	HO1MA10							
254 304	HO22M10 HO37M10 HO24M10 HO27M10 HO47M10 HO7MA12 HO23M12 HO15M12							
304 305 381		B300 B-12 HOH-300 HOH-12 N-300 N-12 HOS-12 HO-12 HJA8-12 HOB-12 HLA6-12 HLA6-12 NL-12 HLA8-15 HLA6-15		HA8-12 HX-12 H-12 SH-12 HH-12 HHL-12 HJ-12 HHJ-12 ZA8-12-78 ZA8-12-85	INTERNATIONAL 9821-53123 9821-63123 9827-TORNADO HIGH SPEED Q.C. 9121-53123 9121-63123 305KB		HSL 315 ROTA NCK315 ROTA NC315 ROTA NCF315	
304	HO1MA12							
304 315		B212 BT212 BL212	LC 315			KFD-HE315		BBM 315
304	HO27M12 HO37M12							
380 450		B380 B-15 HOH-380 HOB-15 HOH-15 B-450 B-18 HOB-18			INTERNATIONAL 9821-53823 9821-63823 HIGH SPEED Q.C. 9121-53823 9121-63823		ROTA NC 400 ROTA NCF 400	
380		B215 N15 N18						
381 450 534		HJ-380 HJA-18 HLA-18 HJA-8-21						
380 450				HA11-15 HHL-15 H-15 HH-15 HA11-18 H-18 HH-18 ZA-15-120			HSL 400	
454 530 610		HJ-450 HJ18 B-530 B-21 HJ-530 HJ-21 HOB-21 N-21 B-600 B-24 HJ-610 HJ24 N24 HOB24 UVE-LB500/630						
610		HOB24 HJA24 HJ24 UVE-LB800						



THAME
ENGINEERING

SERRATED SOFT TOP JAWS

60° SERRATIONS

- Material : 080M15 (En32)
- Black Finish

TO SUIT GAMET, NIKKO AND RÖHM POWER CHUCKS

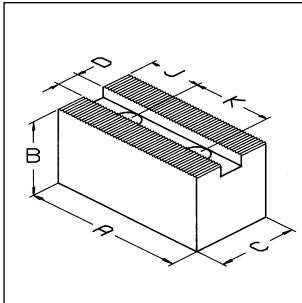

TYPE A

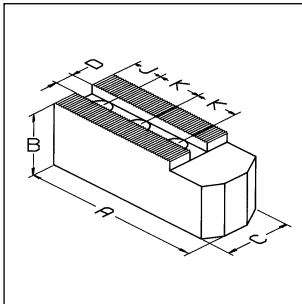

TYPE B

THAME PART No.	A	B	C	D	K+J BOLT	SERRATIONS	TYPE	WEIGHT KG/SET	GAMET	NIKKO	RÖHM
DL 10	53	30	20	10	15+9 M8	1.5 × 60°	A	0.6	105 N 105 MO	HF-4	KFD-HE 130 KFN 105
DL 16	67	40	30	11	20+17 M8	1.5 × 60°	A	1.6	140 DE 160 GO 160 N 170 MF	GO-6 HDM-165 HF-6AB D-170	KFN 160 KFM 160
BT 06	77	35	30		20+9 M8		B	1.3	160 MO 130 N 130 MO	HG-6AB MO 6	KFG 160 KFE 170
DL 22	89	57	32	14	26+18 M10	1.5 × 60°	A	3.1	170 DE 215 MF 215 N	GO-8 MO-8 HF-8 MAC 165	KFN 215 KFM 215
BT 08	102	44	32		22+10 M10		B	2.6	215 MO 215 GO	HG-8 HDM 215	KFG 215 KFE 215
DL 28	89	57	44	20	26+18 M12	1.5 × 60°	A	4.1	250 N 280 N	GO-10 HDM 250 GO-12 HDM 300	KFN 250/280 KFM 280
BT 10	117	51	44		30+13 M12		B	4.9	280 MO 280 GO	HF-10 MO-10 HF-12 MO-12	KFG 280 KFE 280
BT 11	130	51	44		30+13 M12		B	5.4	280 MF	HG-10	
DL 35	120	80	50	21	28+25 M16	1.5 × 60°	A	9.4	350 N 350 MO 350 GO 350 MF	HF-14 MAC 250 HF-16 MAC 315	KFN 350 KFM 350
BT 14	170	65	50		40+22 M16		B	10.0		HDM 250 MO-14 HDM 380	KFG 350 KFE 350

POINTED OR WEIGHT REDUCED SOFT JAWS

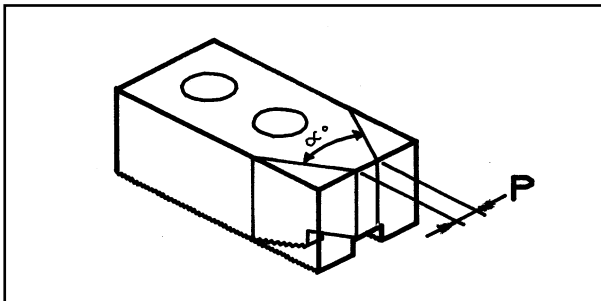

A. Pointed 60° or 120° Inclusive α°

Any standard soft jaw can be pointed or weight reduced, please give following information:-

1. Quantity of sets required.
2. Thame Part No.
3. Modification required.
4. Relevant dimensions.

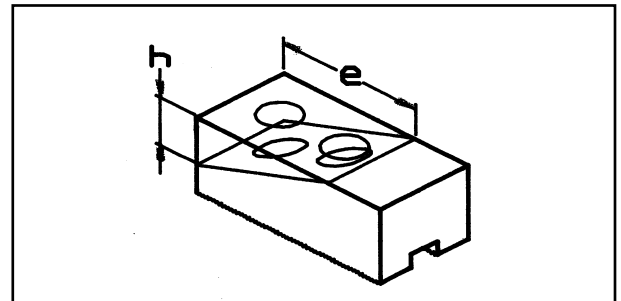

B. Rectangular Weight Reduced

CONVERSION PLATES

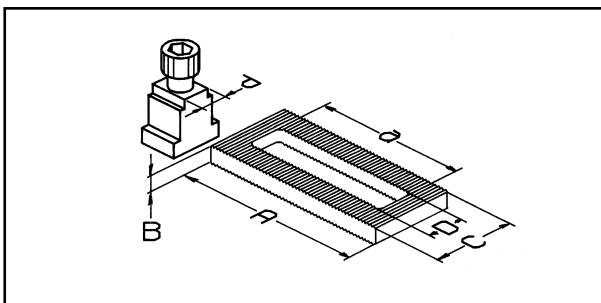

A. Serration to Serration

Allows different top jaws to be used with base jaws of another configuration.
Please contact our sales office for a quotation.

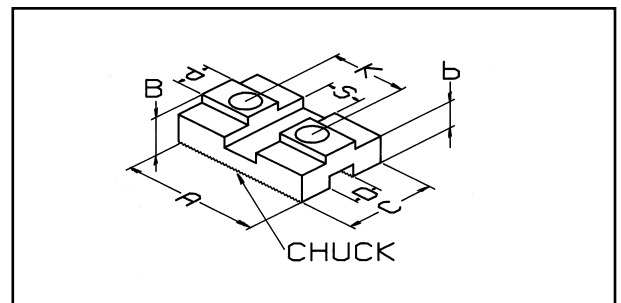

B. Serration to Slot/Tenon



THAME
ENGINEERING

SERRATED SOFT TOP JAWS

90° SERRATIONS

- Material : 080M15 (En32) • Black Finish

TO SUIT SMW-AUTOBLOK LARGE & EXTRA LARGE OPEN CENTRE POWER CHUCKS

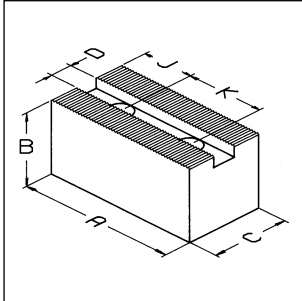

THAME PART No.	A	B	C	D	K+J BOLT	SERRATIONS	WEIGHT KG/SET	AUTOBLOK CHUCK TYPE	
CL 12	60	32	32	12	16+15 M8	1/16" x 90°	1.0	130 BHD 125 ALD	140 BBD 125 AND
CH 17	70	38	32	14	16.5+16 M10		1.3	165 BHD, BHD/FC 165 ALD	175 BBD RCD 165 165 AND
CH 21	90	40	40	17	23+20 M12		2.8	210 BHD, BHD/FC 210 ALD	210 BBD RCD 210 210 AND
CH 25	110	44	44	21	30+20 M16		3.8	250 BHD, BHD/FC 250 ALD	250 BBD RCD 250 250 AND
CH 32	125	50	50	21	30+20 M16		5.5	315 BHD, BND/FC 315 ALD	315 BBD RCD 315 315 AND

TO SUIT PRATT BURNERD CLOSED/OPEN CENTRE WEDGE POWER CHUCKS

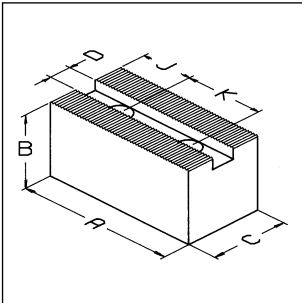

THAME PART No.	A	B	C	D	K+J BOLT	SERRATIONS	WEIGHT KG/SET	PRATT CHUCK TYPE	
BJ 16	62	32	25	12.7	17.5+14 M8	1/16" x 90°	1.2	160 TYPES 1160-/ 1140-/ 1141-/ 1180-	
BJ 20	71	44	32	14.3	20.6+16 M10		2.1	200 TYPES 1160-/ 1140-/ 1141-/ 1180-	
BJ 25	83	50	40	15.9	23.8+17 M12		3.0	250 TYPES 1160-/ 1140-/ 1141-/ 1180-	
BJ 32	108	57	44	17.4	31.8+22 M14		5.2	315 TYPES 1160-/ 1140-/ 1141-/ 1180-	
BJ 40	124	65	50	20.6	38.1+24 M16		8.3	400 TYPES 1160-/ 1140-/ 1141-/ 1180-	
BJ 50	146	80	50	25.4	44.5+29 M20	3/32" x 90°	12.6	500/630 TYPES 1160-/ 1140-/ 1141-/ 1180-	

TO SUIT PRATT BURNERD CONSTANT GRIP POWER CHUCKS

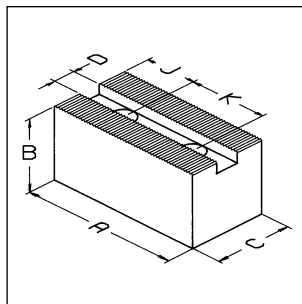

THAME PART No.	A	B	C	D	K+J BOLT	SERRATIONS	WEIGHT KG/SET	PRATT CHUCK TYPE	
BL 16	50	38	32	15	20.6+11 M10	1/16" x 90°	1.0	160 TYPES 1770-/ 1771-/ 1772-	
BL 20	64	40	40	17	25.4+13 M12		1.6	200 TYPES 1770-/ 1771-/ 1772-	
BL 25	80	50	40	17	25.4+13 M12		2.8	250 TYPES 1770-/ 1771-/ 1772-	
BL 32	105	57	44	21	31.8+17 M16		5.0	315 TYPES 1770-/ 1771-/ 1772-	
BL 40	124	65	50	21	38.1+17 M16	3/32" x 90°	8.4	380 TYPES 1770-/ 1771-/ 1772-	

TO SUIT PRATT BURNERD SELF CONTAINED (UP TO 89) POWER CHUCKS

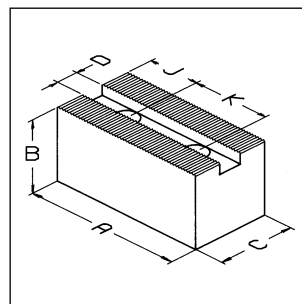

THAME PART No.	A	B	C	D	K+J BOLT	SERRATIONS	WEIGHT KG/SET	PRATT CHUCK TYPE	
BK 16	62	40	25	13	18+14 M8	1/16" x 90°	1.1	160 TYPE 1740-/ 1730-/ 1742-/ 1744-/ 1157-	
BK 20	76	44	32	17	22+16 M10		2.2	200 TYPE 1740-/ 1730-/ 1742-/ 1744-/ 1157-	
BK 25	89	60	40	21	25+19 M12		3.7	250 TYPE 1740-/ 1730-/ 1742-/ 1744-/ 1157-	
BK 32	105	60	40	21	30+22 M12		4.5	315 TYPE 1740-/ 1730-/ 1742-/ 1744-/ 1157-	



THAME
ENGINEERING

SERRATED SOFT TOP JAWS

90° SERRATIONS

- Material : 080M15 (En32)
- Black Finish

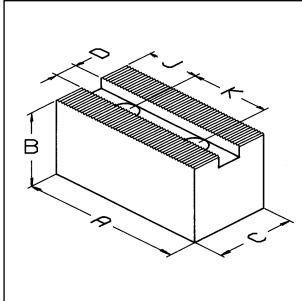

TYPE A

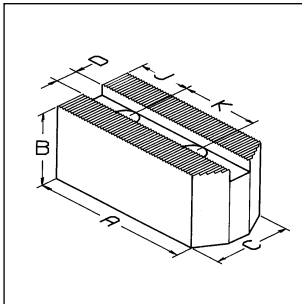

TYPE B

THAME PART No.	A	B	C	D	K + J BOLT	SERRATIONS	TYPE	WEIGHT Kg/Set
BV 13	52	25	25	12	14 + 8 M8	1/16 x 90°	A	1.0
RD 13	55	38	32	12	16 + 10 M8	1/16 x 90°	A	1.2
CL 12	60	32	32		16 + 15 M8		A	1.0
BV 16	72	38	32	12	20 + 10 M10	1/16 x 90°	A	1.4
CL 17	80	38	32	14	20 + 19 M10	1/16 x 90°	A	2.2
BM 16	65	40	40	17	22 + 15 M12	1/16 x 90°	A	1.3
BN 70	70	60	40				A	2.7
BN 75	80	40	40				B	2.5
BL 20	64	40	40	17	25.4 + 13 M12	1/16 x 90°	A	1.6
BL 25	80	50	40				A	2.8
BN 80	90	40	40		22 + 15 M12		A	2.8
BN 85	90	40	40				B	2.7
BN 90	90	60	40				A	3.7
BL 32	105	57	44	21	31.8 + 16 M16	1/16 x 90°	A	5.0
BM 32	116	65	50				A	7.6
BN 10	120	50	50		28 + 20 M16		A	5.4
BN 11	120	50	50				B	5.3
BN 12	120	80	50		28 + 20 M16		A	9.4
BN 14	140	50	50				A	6.3
BN 15	140	50	50				B	6.2
BN 13	140	89	64	25.5	35 + 30 M20	1/16 x 90°	A	15.0
BM 40	152	76	64	25.5	44.5 + 20 M20	3/32 x 90°	A	14.3
BN 23	155	89	64		35 + 30 M20		A	17.4
BJ 50	146	80	50	25.4	44.5 + 29 M20	3/32 x 90°	A	12.6
CL 50	160	76	64	28	38 + 25 M20	3/32 x 90°	A	14.5



THAME
ENGINEERING

To Suit Autoblok, Berg, Forkardt, Gamet, Geiger & Haag, Pratt Burnerd, Röhm, Schunk & SMW Power Chucks

AUTOBLOK & SMW-AUTOBLOK	BERG	FORKARDT	GAMET	GEIGER & HAAG	PRATT BURNERD	RÖHM	SCHUNK	SMW
					125 INTERNATIONAL 150 KB INTERNATIONAL			
IND 125 AND 125 ALD 125 GHDN 125	KF 130	KIH 130/140		GHHY 120-130 GHGY 160-200	170 KB INTERNATIONAL	KFD 130 KFH 140	HSG 160-46	KDV 130 KMA 140 KMAF 140
					135 HYD. FRONT END 165 INTERNATIONAL 165 HIGH SPEED Q.C.			
IDN 170, HDB 170 IDL 170 HDN 170 GHDN 165 GHD/FC 165 AND 165, ALD 165			MAC 165/170 DE 170 GA 160/170				TP 160	SP 160
IDN 200/220 IDL 200 HDN 200/220 HDL 200 GHDN 210 CD 200 GHD/FC 210 HDB 220 AND 210 ALD 210	KF 160 HES 160 KHFF 200 KF 200 HES 200 HESF 160/200	3KGF 160/175/200 KTG 160/200 KIN 160/200 3KGFH 160/175/200 KS 160/200/250 KL 160/200 KSPS 160/200 KSF 175/200 3KTGF 200 KSHF 200 UVE 160/200/250 KP 200 KG 200 3NHf 200 3NH 200 KSH 160/200 KLNC 200 KT 160/200 KTF 200 KIH 200/250/315 QLC 175	MAC 200 MAC 220 DE 210 GA 210	GHHFA 175 GHHFA 200/250 GHN 160/200 GHS 160/200 GHSK 160/200/250 GHL 160/200 GHL 160/200/250 GHHF 160/190/210/225 GHSP/GHHSP 160/215 GHL 250 MO GHSK 160/200/250	160 INTERNATIONAL (UP TO 89) 160 HIGH SPEED Q.C. (UP TO 89) 165 HYD. FRONT END 210 INTERNATIONAL 210 HIGH SPEED Q.C. 210 KB INTERNATIONAL 210 KB HIGH SPEED QC	KFH 160/200 KFH-NC 160/200 KFH-F 160/200 KFH-G 160/200 KFD-HF 160/200 KFD-HE 160/200 KFD-HS 200 KFD 160/200 SPD 160/200 SPO 160/215 KFD-AF 160	THF 165-37 TH 165-37 HGS 200-66 HSL 165-37 ROTA NCF 165 ROTA NCF 160 ROTA NCO 165	HFKS 160/200 KDV 160/200/250 KDVG 160/200/250 KDM 160/200 KDM-F 160/200/250 KMA 160/200/250 KMAF 160/200/250 KFV 160/200 SP 200 KFMF 160/200 HFK 160/200
IDN 200/220 IDL 200 HDN 200/220 HDL 200 GHDN 210 CD 200 GHD/FC 210 HDB 220 AND 210 ALD 210	KF 200 HES 200 KHFF 200 HESF 200	3KGF 200 KTG 200 3KGFH 200 KIN 200 KS 200/250 KSH 200 KL 200 KSF 200 3KTGF 200 KSHF 200 UVE 200/250 KG 200 KSPS 200 3NHf 200 KSHF 250-55 (INDEX) 3NH200 3NHf 250-65 (INDEX) 3NHf 290-104 (INDEX) KL 250 MO KS 250 MO KLNC 200 KP 200 KT 200 KIH 200/250/315 QLC 210	MAC 200 MAC 220 DE 210 GA 210	GHHFA 200/250 GHN 200 GHSN 200 GHSK 200/250 GHL 200 GHL 200/250 GHHF 190/210/225 GHGY 250/300 GHL 250 MO GHSP/GHHSP 215 GHSK 160/200/250	200 INTERNATIONAL (UP TO 89) 200 HIGH SPEED Q.C. (UP TO 89) 210 HYD. FRONT END 250 HIGH SPEED Q.C. (UP TO 89) 254 INTERNATIONAL 265 HIGH SPEED Q.C. 265 KB INTERNATIONAL 265 KB HIGH SPEED Q.C.	KFH 200 KFH-NC 200 KFH-F 200 KFH-G 200 KFH-HF 200 KFD-H-E 200 KFD-HS 250 KFD-AF 200 SPO 215 SPD 215 KFD 200/250	THF 210-52 TH 210-52 HSG 250-91 HSL 210-52 ROTA NC 210 ROTA NCD 210 ROTA NCF 200 ROTA NCO 200 TP 200	HFKS 200 KDV 200/250 KDVG 200/250 KDM 200 KDM-F 200/250 KMA 200/250 KMAF 200/250 KFV 200 KFMF 200 HFK 200
IDN 250/315/400 IDL 250/315/400 HDN 250/315/400 HDL 250/315/400 GHDN 250/315/400 CD 250/315 GHD/FC 250/305/400 HDB 300 AND 250 ALD 250 AND 315 ALD 315	KF 250 HES 250 KHFF 250 HESF 250 KF 315 HES 315 KHFF 315 HESF 315	KS 315/400 KSH 250/315/400 KG 250/315 KP 250/315 3KTGF 250/315 KT 250/315 UVE 315 KSHF 250/315/400 KTG 250/315 KLNC 250/315 KIN 250/315 KIF 250/315 3NHf 250/315 3NH 250/315 3NHf 290 3NHf 400 (INDEX) KL 250 KSPS 250/300 QLC 250/315	MAC 250 MAC 315 DE 250/260/320 GA 250/315	GHN 250/315 GHS 250/315 GHSK 315 GHL 250/280 GHL 280 GHSP/GHHSP 300	250 INTERNATIONAL (UP TO 89) 254 HYD. FRONT END 305 HYD. FRONT END 305 INTERNATIONAL 305 HIGH SPEED Q.C. 315 INTERNATIONAL (UP TO 89) 400 HIGH SPEED Q.C. (UP TO 89) 305 KB INTERNATIONAL 305 KB HIGH SPEED Q.C.	KFH 250/315 KFH-NC 250/315 KFH-F 250/315 KFH-G 250/315 KFH-HF 250/315 KFD 250/315 KFD-HF 250/315 KFD-HE 250/315 KFD-HS 315 KFD-AF 250/315 LVE 305 SPO 300 SPD 300	THF 250-71 TH 250-71 THF 315-86 TH 315-86 HSG 315-108 HSL 250-71 HSL 315-91 ROTA NC 250/315 ROTA NCD 250/315 ROTA NCF 250/315 ROTA NCO 250/315 TP 250/315	HFK 250/315 HFKS 250/315 KDV 315/400 KDVG 315/400 KDM 250/315/400 KDM-F 315/400 KMA 315/400 KMA-F 315
		KL 300 KSHF 560	MAC 380					
IDN 500/630/800 IDL 500/630/800 GHDN 500/610/640/800 ALD 400 AND 400	KF 400/500/630 HES 400/500/630 KHFF 400 KFF 400/500/630 HESF 400/500 HESF 630	KS 500/620 KSH 500 KSL 630 KSHF 630 3KTGF 400/500 UVE 400/500/630/800 KTG 400/500 KIN 400/500 KG 400/500 3NHf 400/500/630 3NH 400/500/630 KL 400/500 KLNC 400/500 KP 400 KT 400/800 KTF 400/500 QLC 400	DE 400		400 INTERNATIONAL (UP TO 89) 400 HYD. FRONT END 500 HYD. FRONT END	KFH 400/500 KFH-F 400/500 KFH-NC 400/500 KFD 400/500/630/800 KFD-H 400/500 KFD-HF 400/500 KFD-HS 400/500 LVE 400/500/630/1000 KFL 500/630	THF 400-120 TH 400-120 THF 500-160 TH 500-160 TH 630-180 HSG 400-176 HSG 500-165 HSL 400-120 ROTA NC 400 ROTA NCD 400 ROTA NCF 400 ROTA NCO 400	HFK 400/500 HFKS 400/500 KDV 500 KDVG 500 KDM 500 KFV 400/500/630/800
					380 INTERNATIONAL 380 HIGH SPEED Q.C.			
IDN 500/630/800 IDL 500/630/800 GHDN 500/610/640/800 HDL 500/630/800 HDW/FC 500/630								



THAME
ENGINEERING

SERRATED SOFT TOP JAWS

90° SERRATIONS

- Material 080M15 (En32)
- Black Finish

TO SUIT BERG KH POWER CHUCKS

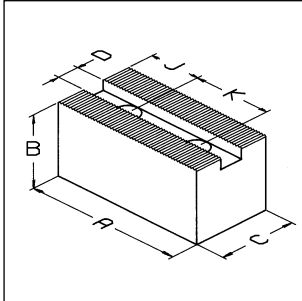

THAME PART No.	A	B	C	D	K & J BOLT	SERRATIONS	WEIGHT KG/SET	BERG CHUCK TYPE
CS 14	55	35	22	8	14+11 M8	1/16" x 90°	0.7	KH 110
CS 16	70	45	25	10	20+15 M10		1.4	KH 140-36 / KH 140-45 / KH 160
CS 18	80	57	32	12	21+15 M12		3.6	KH 175-56 / KH 200-68
CS 20	90	57	32	12	21+15 M12		3.8	KH 175-56 / KH 200-68
CS 25	111	60	40	16	29+18 M16		4.7	KH 250-91 / KH 315-117
CS 40	150	80	50	20	38+31 M20	3/32" x 90°	8.4	KH 400 / KH 500 / KH 630

TO SUIT SCHUNK & SMW-AUTOBLOK PNEUMATIC POWER CHUCKS

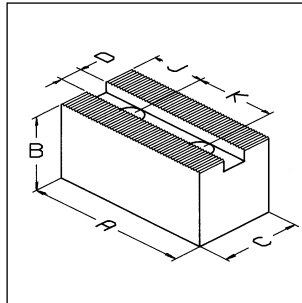

THAME PART No.	A	B	C	D	K & J BOLT	SERRATIONS	WEIGHT KG/SET	CHUCK TYPE	
								SMW-AUTOBLOK	SCHUNK
CO 13	68	40	30	11	18+21 M8	1/16" x 90°	1.6	SP 125 / STP 125 / STWP 125	TP 125
CO 16	88	51	32	14	25+25 M10		2.9	SP 160 / STP 160 / STWP 160	TP 160
CO 20	98	50	40	17	29+25 M12		4.0	SP 200 / STP 200 / LP 205 / STWP 200	TP 200
CO 25	108	70	50	21	30+28 M14*		8.0	SP 250 / STP 250 / LP 250 / STWP 250 SP 315 / STP 315 / LP 305 / STWP 315	TP 250
CO 32	120	70	50	21	30+28 M14*		10.1	SP 315 / STP 315 / LP 305 / STWP 315	TP 315
CO 35	132	70	50	21	30+28 M14*		11.5	SP 315 / STP 315 / STWP 315	

*Please note, for 250mm Chucks upwards after mid 1997 bolt sizes changed to M16. Please specify.

TO SUIT SCHUNK & SMW-AUTOBLOK BIG BORE POWER CHUCKS

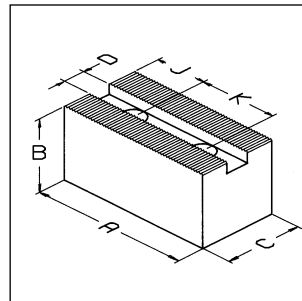

THAME PART No.	A	B	C	D	K & J BOLT	SERRATIONS	WEIGHT KG/SET	CHUCK TYPE	
								SMW-AUTOBLOK	SCHUNK
CP 40	158	76	64	25.5	40+35 M18*	3/32" x 90°	15.0	BB400 / BB400-ES / STP 400 / LP 380-460	TB 400
CP 50	185	76	64	25.5	40+35 M18*		18.0	BB500 / BB500-ES, BB630-ES265 STP 500 / LP 500	TB 500
CP 63	240	102	76	30	64+40 M24		35.0	BB630 / BB630-ES325 / STP 630	TB 630
CP 80	300	102	76	30	64+40 M24		43.0	BB800 / BB1000 / STP 800	TB 800, TB 1000

*Please note, after mid 1997 M18 bolt sizes change to M20. Please specify.

TO SUIT RÖHM KFD-HS POWER CHUCKS

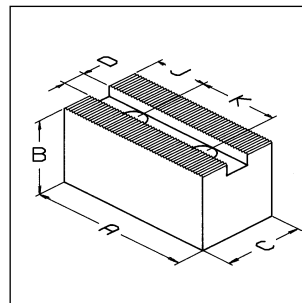

THAME PART No.	A	B	C	D	K & J BOLT	SERRATIONS	WEIGHT KG/SET	RÖHM CHUCK TYPE
BI 14	53	45	25	10	12+12+9 M6*	1/16" x 90°	1.1	KFD-HS 130 KFD-HS 140
BI 17	55	57	32	12	15+9 M8		1.9	KFD-HS 160 KFD-HS 175
BI 20	70	60	40	17	19+12 M12		3.1	KFD-HS 200
BI 25	90	60	40	17	19+12 M12		4.2	KFD-HS 250
BI 32	105	60	50	21	25+15 M16		6.0	KFD-HS 315
BI 40	140	89	64	25.5	31+20 M20	3/32" x 90°	14.5	KFD-HS 400 KFD-HS 500

*This jaw has three holes and is pointed



THAME
ENGINEERING

SERRATED SOFT TOP JAWS

90° SERRATIONS

- Material : 080M15 (En32)
- Black Finish

**TO SUIT AUTOBLOK, FORKARDT, GEIGER & HAAG,
RÖHM & SMW 2 JAW POWER CHUCKS**

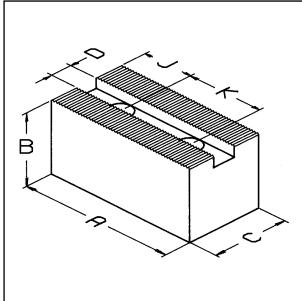

THAME PART No.	A	B	C	D	K+J BOLT	SERRATIONS	WEIGHT KG/SET	AUTOBLOK	FORKARDT	GEIGER & HAAG	RÖHM	SMW
DS 20	95	70	70	21	27+22 M16	1/16" x 90°	7.2	2CLD 200	2BLE 200	GHE 200	KFD-G-200 KFA 200	KZF 200
DS 25	110	70	70	25.5	35+20 M20		7.6	2CLD 250	2BLE 250	GHE 250	KFD-G-250 KFA 250	KZF 250
DS 32	125	80	80	25.5	35+28 M20		10.6	2CLD 315	2BLE 315	GHE 315	KFD-G-315 KFA 315	KZF 315
DS 40	150	80	80	25.5	35+28 M20		13.0		2BLE 400 2BLE 500		KFD-G-400	KZF 400

TO SUIT GAMET POWER CHUCKS

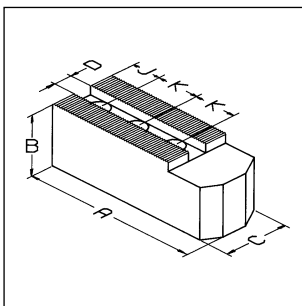

THAME PART No.	A	B	C	D	K+J BOLT	SERRATIONS	WEIGHT KG/SET	GAMET CHUCK TYPE				
BU 06	77	35	30	11	20+9 M8	1/16" x 90°	1.3	160 N / 160 MO / 160 GP				
BU 08	102	44	32	14	22+10 M10		2.6	215 N / 215 MO / 215 GP				
BU 11	130	51	44	20	30+13 M12		5.4	250/280 N / 280 MO / 280 GP				
BU 14	170	65	50	21	40+22 M16		10.0	350 N / 350 MO / 350 GP				

TO SUIT COVENTRY AND TUDOR MANUAL CHUCKS

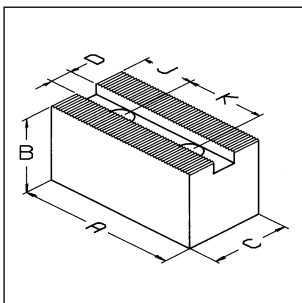

THAME PART No.	A	B	C	D	K+J BOLT	SERRATIONS	WEIGHT KG/SET	COVENTRY	TUDOR
AJ 06	57	32	25	12.7	12.7+16		0.9		
AL 06	67	50	25		5/16 BSW	1/16" x 90°	1.8	6" & 7 1/2" Coventry	6 1/2" Tudor
AM 06	76	32	25				1.2		
AJ 07	64	32	25	14.3	17.5+21		1.2		
AL 07	76	50	25		3/8 BSW	1/16" x 90°	2.1		7 1/2" Tudor
AM 07	89	32	25				1.7		
AJ 09	70	44	32	15.9	15.9+21		1.9		
AL 09	82	70	32		7/16 BSW	1/16" x 90°	3.5	9" Coventry	9" Tudor
AM 09	102	44	32				2.9		
AJ 12	76	51	38	17.5	23+19		2.8		
AL 12	102	76	38		1/2 BSW	1/16" x 90°	5.7	12" Coventry	12" Tudor
AM 12	114	51	38				4.4		
AJ 15	95	57	44	20.6	30.2+25.4		4.4		
AL 15	121	89	44		5/8 BSW	1/16" x 90°	9.0	15" Coventry	15" Tudor
AM 15	140	57	44				6.9		
AJ 18	108	65	50	25.4	34.9+27		7.0		
AL 18	140	90	50		3/4 BSW	3/32" x 90°	12.9	18" Coventry	18" Tudor
AJ 21	140	80	50	25.4	41.3+43		12.0		
AL 21	171	125	50		3/4 BSW	3/32" x 90°	24.0	21" Coventry	21" Tudor
AJ 25	159	80	50	25.4	54+41		14.3		
AL 25	197	125	50		3/4 BSW	3/32" x 90°	33.2	25" Coventry	25" Tudor 29" Tudor